

Bearing No. Y1616

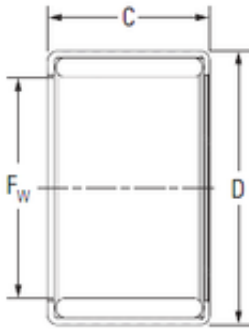

Size	25.4x31.75x25.4 mm
Bore Diameter	25,4 mm
Outer Diameter	31,75 mm
Width	25,4 mm
F _w	25,4 mm
D	31,75 mm
C	25,4 mm
Weight	0,045 Kg
Basic dynamic load rating (C)	30,4 kN
Basic static load rating (C ₀)	78,3 kN